



Launch and Recover with ease

Introducing Compact and Practical
LARS from Bell Hydromatics



www.bellfluid.com

LARS ASSEMBLY SPECIFICATION

BHLR-SL2 Launch & Recovery Systems (LARS) is a specialized compact alternative to standard systems for launching and recovering. This described configuration is highly practical for handling 2 driver's air basket. The A-Frame design can be folded and placed in a standard 20-foot container for easy transport. Different layouts are possible and can be tailored to specific needs.

Description	Length	Width	Height	Weight
LARS Assembly (Transport Mode)	3175 mm	2000 mm	2200 mm	4 ton
LARS Assembly (On Board Ship)	3175 mm	2000 mm	3780 mm	4 ton



TECHNICAL SPECIFICATION

Wire Rope Length

50-75 Meters (Subject to Vessel Freeboard)

Testing Standards

IMCA D018

Testing Witness

DNV GL and ABS

Basket /Cage Cylinder Provision

One/Two 50 Liter Cylinder

HPU Electrical Requirements

380-440V 3PH 50/60 Hz 11 kW/15 HP
(Primary and Standby)

Clump Wire Capacity

13mm dia. Length 160 mtrs Non-rotating
(150 M installed)

Basket Material

Mild Steel or Stainless Steel (Option specified)

Certification

IMCA D023 & IMCA D018

Design Guidelines

IMCA D023

Oil Capacity

2x100 Liter (Primary + Standby)

Main Lift Wire Capacity

13mm dia. Length 160 mtrs Non-rotating
(90 M installed)

Transportation

Fits into a Standard 20ft Shipping container in a resting position

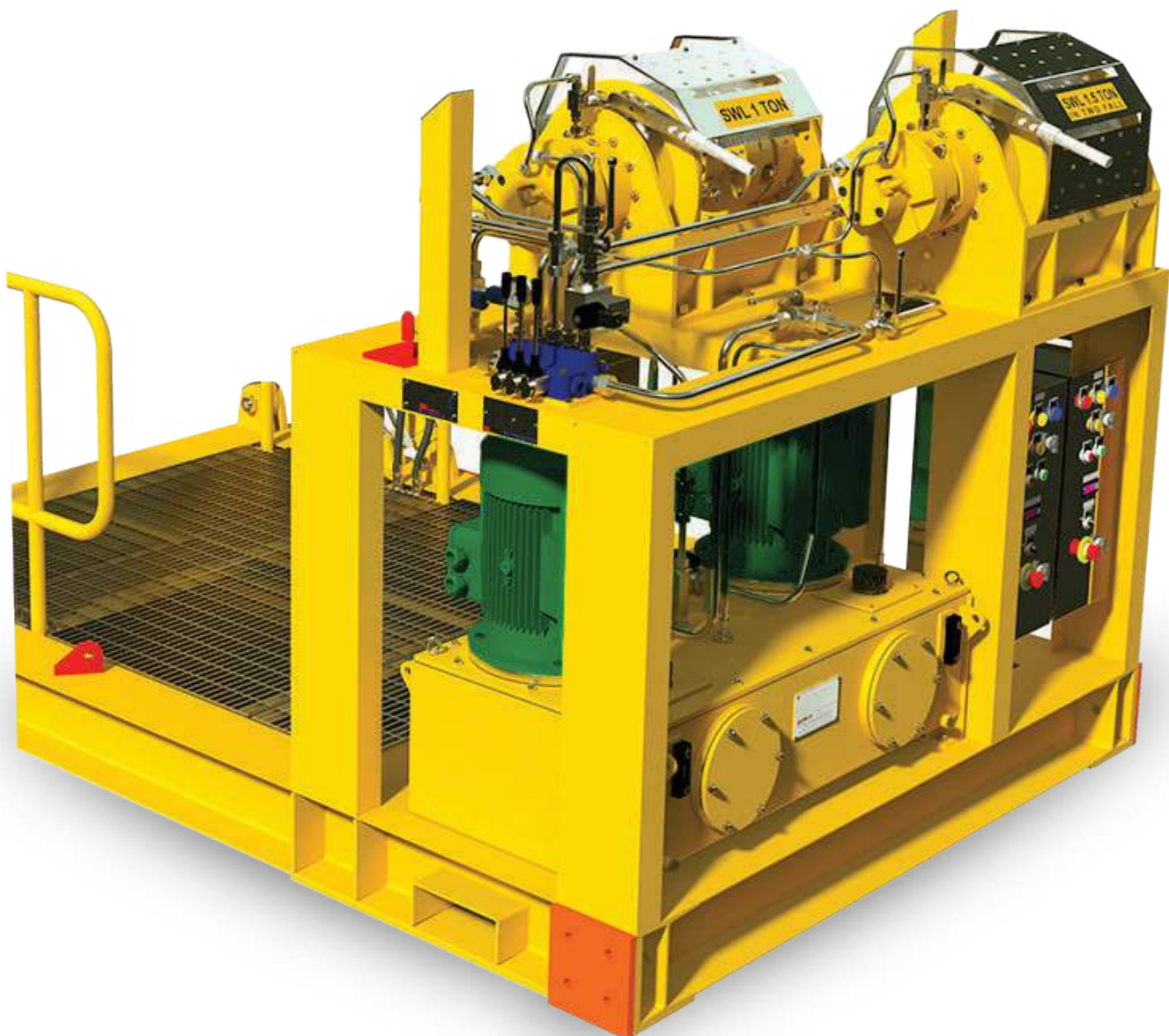

BASKET WINCH

Bell 1 ton man riding winch specifications

Minimum Lift Capability	1 Ton (1000 kg)
Wire Diameter	13 mm Non-rotating
Drive System	Hydraulic Motor
Maximum Lifting Speed	Operator Controllable upto 20 m per minute
Maximum Drum Wire Capacity	160 m of 13 mm diameter
Finish	Painted steel construction, with primer and high gloss epoxy paint
Braking	<ol style="list-style-type: none">1. Automatic Multi Disc Brake2. Dynamic - Hydraulic over-center valve3. Emergency - Band Brake on the drum with manual activation

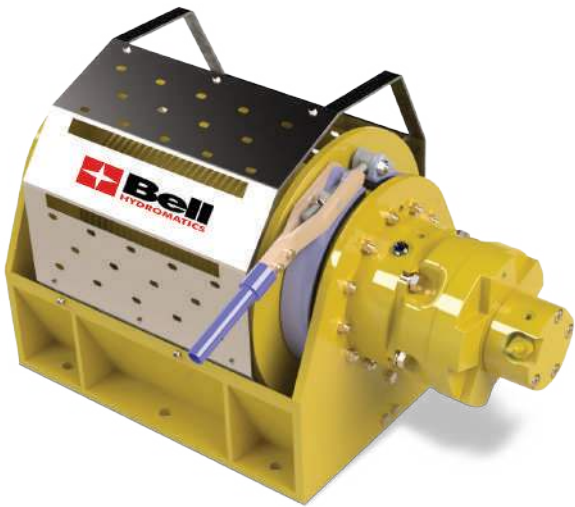

CLUMP WEIGHT HYDRAULIC WINCH

Bell 1 ton man riding winch specifications

Minimum Lift Capability	1 Ton (1000 kg)
Wire Diameter	13 mm Non-rotating
Drive System	Hydraulic Motor
Maximum Lifting Speed	Operator Controllable upto 20 m per minute
Maximum Drum Wire Capacity	160 m of 13 mm diameter

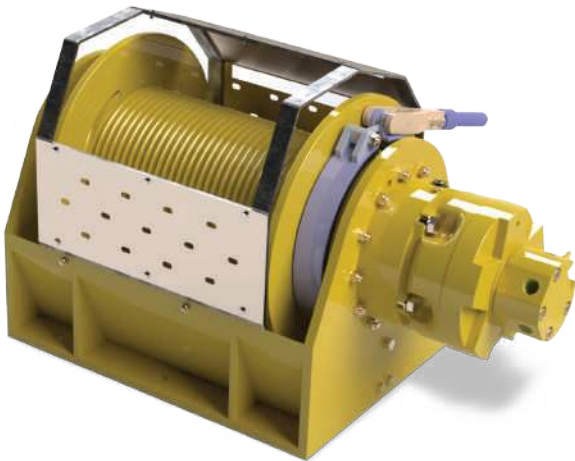

A-FRAME SYSTEM

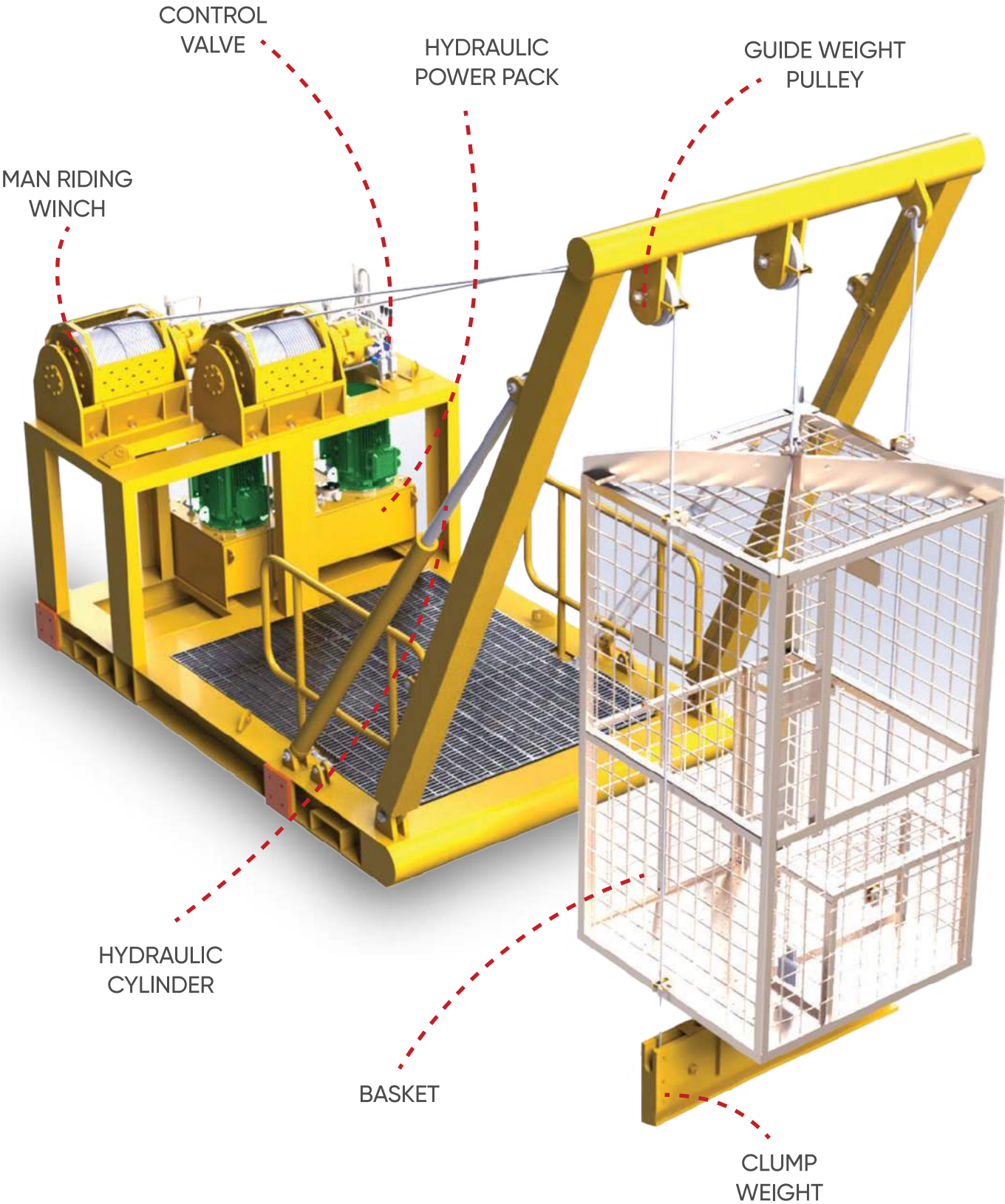

DIVING CAGE/BASKET

- 1.2 x 1.2-meter diving cage with overhead protection frame
- The cage includes diving cylinder securing brackets and safety access chain. Handholds and a diver emergency recovery hard point are provided
- Storage space for 1 or 2 x 50 ltr cylinders (Cylinders not included as part of the cage supply)
- Guide-wire holding rollers
- The cage is manufactured from square tubular, stainless steel sections
- The cage is supplied load tested
- An ID plate is fixed to the basket with TPI stamping. The SWL is marked on the basket

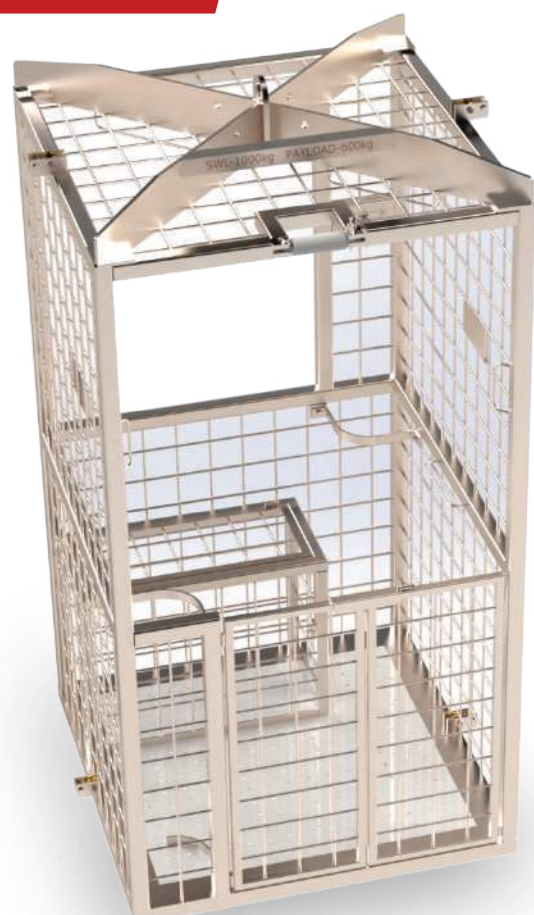

CERTIFICATE PROVIDED WITH LARS

A Frame	DVN GL Load Test
Winch	Man Riding Certificate and DNV
Wire Rope	Supplied by Manufacturer
LARS	DNV
Lifting Slings	DNV
Basket	Load Test Certificate
IMCA	D018 / D023
Paint	FROSIO (Norway) (Certified Surface Treatment Inspector Level III)
FMEA	As-Built by Bell

HYDRAULIC POWER PACK SPECIFICATIONS

Twin Power Pack

Primary Motor & Pump rated as follows:

11 kW /15 hp power 415 v/50/60 hz
(power as determined)

39 ltr/min at 150 bar

Secondary Motor & Pump rated as follows:

11 kW /15 hp, 415 v/50/60 hz (power
as determined)

39 ltr/min at 150 bar

200 Litre Common Hydraulic Oil Tank with
partition up to full oil level

Hydraulic Oil Filter System X 2

Two Independent Electrical Stainless Steel
Control Panels are Mounted on the Skid,
for the Primary and Secondary Power Packs

Independent Power Pack

11 kW /15 hp power 415 v/50/60 hz
(power as determined)

39 ltr/min at 150 bar

Hydraulic oil filter system

1 nos. independent stainless steel electrical
control panel is mounted on the skid

These independent power packs can be used
as primary and secondary power packs

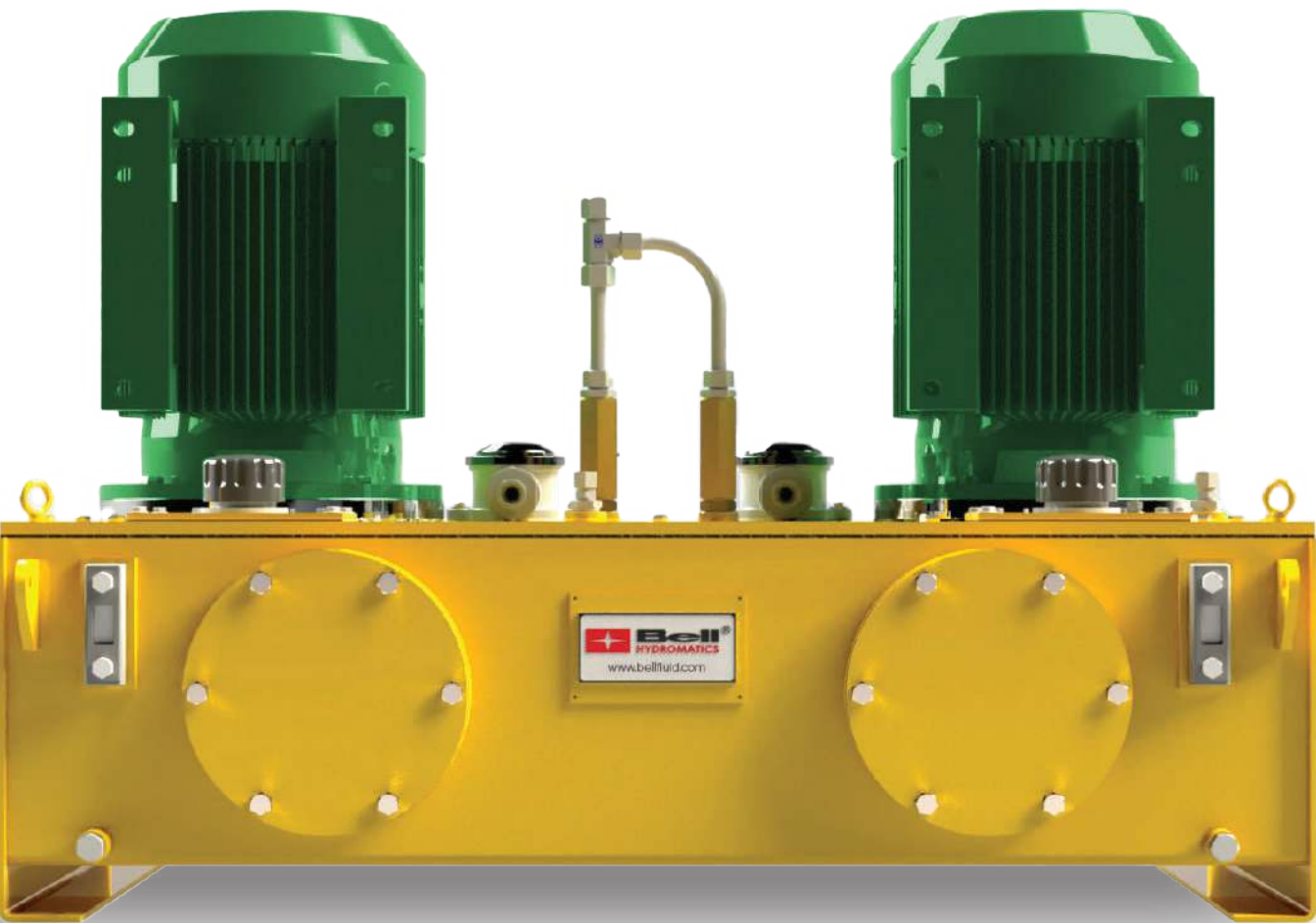



CONTACT

For Sales Inquiry

+91 900 432 2577 | +91 845 108 1000

HEAD OFFICE

A-238, TTC Industrial Area, MIDC Mahape,
Navi Mumbai – 400710, Maharashtra, India

snw@bellhydromatics.com

sales@bellhydromatics.com